

**SPCO**  
makes life easier



**HM, HMK, HMC, HMN**

Horizontal Multistage  
Centrifugal Pumps, 50Hz

# Approvals

**electrosuisse** 

## Expert's report

Confirmation on preparation of an expert's report

**CERTIFID** Expert ref no. CH-18-06-0172-Exp-B  
page 1 of 1

|                                |  |
|--------------------------------|--|
| <b>Product</b>                 | Horizontal and vertical pumps  |
| <b>Applicant</b>               | Swiss Pump Company<br>Muesweg 36, CH-3645 Gwatt  |
| <b>Manufacturer</b>            | Swiss Pump Company<br>Muesweg 36, CH-3645 Gwatt  |
| <b>Manufacturer at Factory</b> | Swiss Pump Company<br>Muesweg 36, CH-3645 Gwatt  |
| <b>Trade-mark</b>              | SPCO, SWP  |
| <b>Type/Model</b>              | HD, CCS, SB, SBP, V40, V40C, V40L, CGL, CHL, CH, CGLF, CGLFT, CHLFT, SCF, PG, V40C, V40L, V40S |
| <b>Rating characteristics</b>  | 120-240V, 3x220V, 3x400V, 3x480V, 50/60Hz<br>Power range = 30 - 1800W, IP55                    |
| <b>Standards safety</b>        | EN 60204-1:08 + A1:09<br>IEC 60334-1:04 EuroT  |
| <b>Standards EMC</b>           | ---  |
| <b>Other standards</b>         | ---  |

For the product an expert's report with regard to the aforementioned normative documents, respectively technical features has been issued.  
The results are given in the reports ref no.  
18-06-0172-01

**Electrosuisse  
National Certification Body**

Mark: Plus  
Product Certification: 

  
SCS 200  
(EN 45011)  
Fertigkeit, 2010-06-18

SWP: Hersteller für Pumpen, Dräger- und Rohrleitungsanlagen  
SCS 200: Hersteller für Normen- und Regelwerke für die Fertigung  
IEC: Internationaler Elektrotechnischer Ausschuss  
EN: Europäische Normen für Maschinenbau, Elektrotechnik, Maschinenbau, Elektrotechnik, Maschinenbau, Elektrotechnik



THE INTERNATIONAL CERTIFICATION NETWORK

## CERTIFICATE

IQNet and SQS  
hereby certify that the organisation

**Swiss Pump Company AG**  
3645 Thun-Gwatt  
Switzerland

*Certified area*  
**Whole Company**

*Field of activity*  
**Design, development, manufacture and sale of products  
for the transportation of liquids**

has implemented and maintains a  
**Management System**  
which fulfills the requirements of the following standard(s)

**ISO 9001:2008**

Scope No(s): 17, 18, 19  
Issued on: 2012-02-20  
Validity date: 2015-02-19  
Registration Number: **CH-32160**

  
  
 Michael Drechsel  
President of IQNet

  
 Roland Glauser  
Managing Director SQS



IQNet Partners:  
AENOR Spain AFNOR Certification France AIS-Vincotte International Belgium ANCE Mexico APCER Portugal CCC Cyprus  
CISQ Italy CQC China CQM China CQS Czech Republic Cio Cert Croatia DQS Holding GmbH Germany ISR Denmark  
ELOT Greece FCM Brazil FONDONORMA Venezuela ICONTEC Colombia IMC Mexico INKORP Tunisia  
Inspecta Certification Finland IRAM Argentina JQA Japan KPC Korea MSZT Hungary Nemko AS Norway NSAI Ireland  
PCBC Poland Quality Austria RR Russia SRI Israel SIO Slovenia SIRIM QAS International Malaysia SQS Switzerland SRAC Romania  
TEST St Petersburg Russia TSE Turkey VDUQS Serbia  
IQNet is represented in the USA by: AFNOR Certification, CISQ, DQS Holding GmbH and NSAI Inc.  
\* The list of IQNet partners is valid at the time of issue of this certificate. Updated information is available under [www.iqnet-certification.com](http://www.iqnet-certification.com)



## General Data

|                                |      |   |
|--------------------------------|------|---|
| Performance range              | page | 4 |
| Applications HM - HMK          |      | 5 |
| Pump HM - HMK                  |      | 5 |
| Operating Conditions HM - HMK  |      | 5 |
| Pipe Connections               |      | 5 |
| Liquids to be pumped           |      | 5 |
| Applications HMC - HMN         |      | 6 |
| Pump HMC - HMN                 |      | 6 |
| Operating Conditions HMC - HMN |      | 6 |
| Pipe Connections               |      | 6 |
| Definition of model            |      | 7 |
| Electrical Motor               |      | 7 |
| Section drawing HM - HMK       |      | 8 |
| Material HM - HMK              |      | 8 |
| Mechanical seal HM - HMK       |      | 8 |
| Section drawing HMC - HMN      |      | 9 |
| Material HMC - HMN             |      | 9 |
| Mechanical seal HMC - HMN      |      | 9 |

## Technical Data

|             |      |    |
|-------------|------|----|
| HM - HMK 2  | page | 10 |
| HM - HMK 4  |      | 11 |
| HM - HMK 8  |      | 12 |
| HM - HMK 12 |      | 13 |
| HMC - HMN 2 |      | 14 |
| HMC - HMN 4 |      | 15 |
| HMC 8       |      | 16 |
| HMC 12      |      | 17 |

Performance range

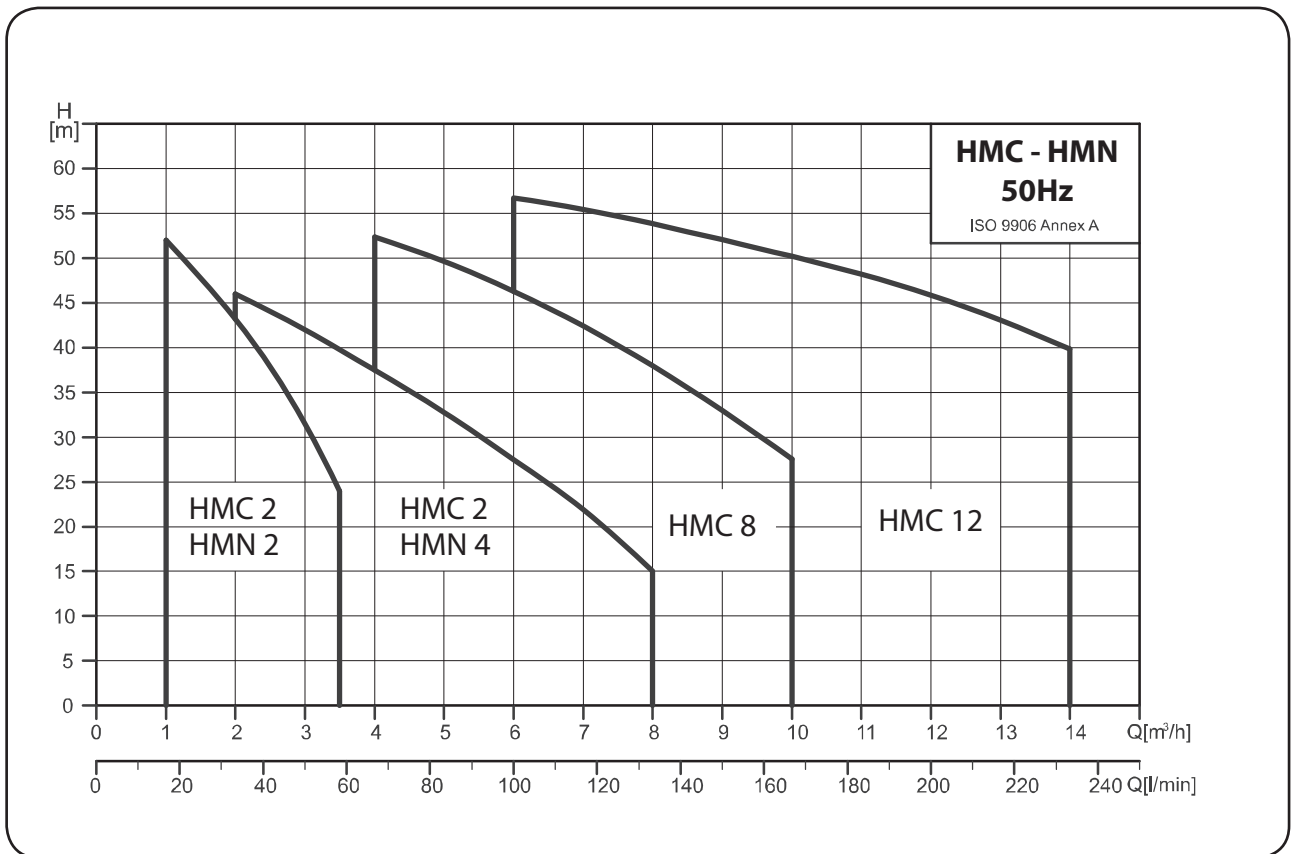
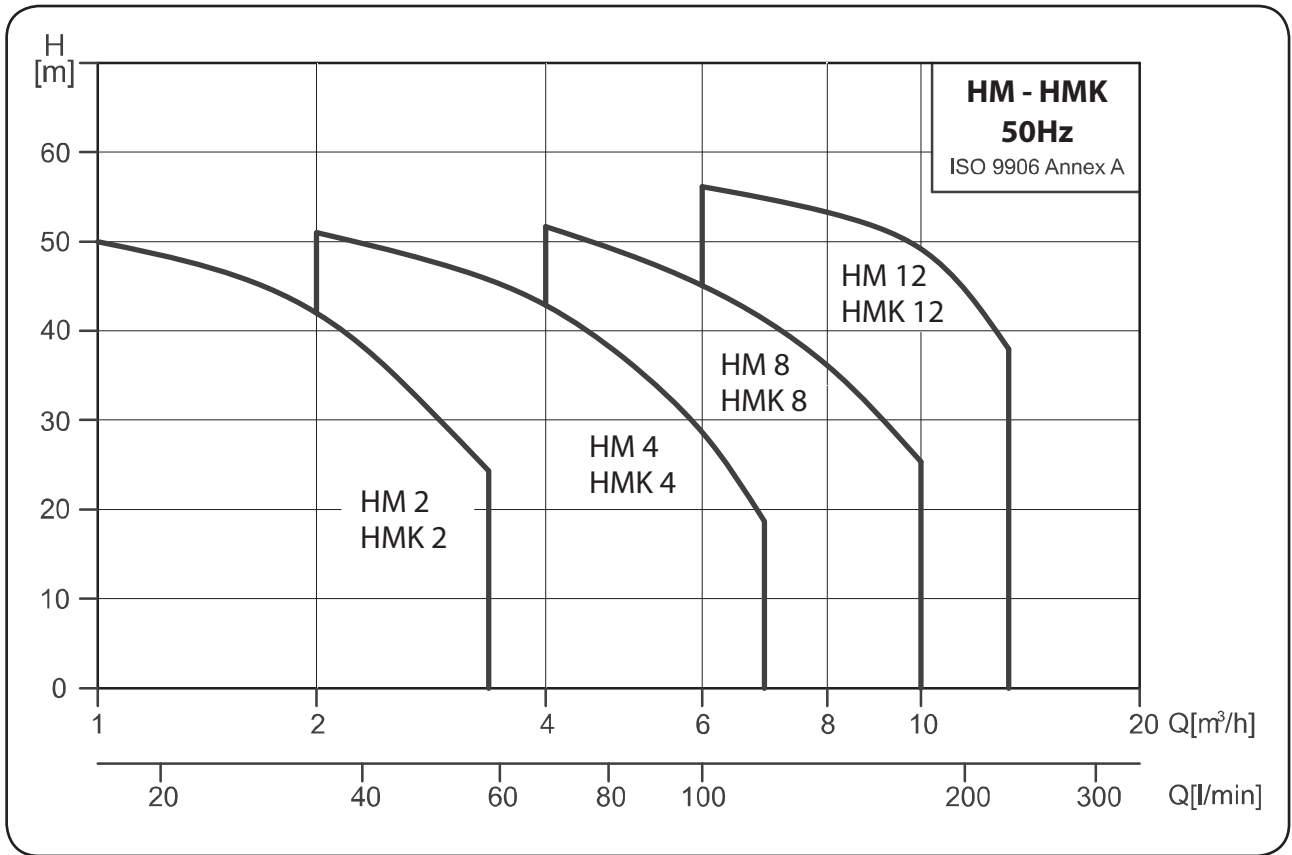

## Applications HM - HMK

- Water supply and pressure boosting.
- Water treatment.
- Air-conditioning.
- Heating and cooling in industrial processes.
- Industrial washing and dish-washing machines.
- Softened water.
- Pressure boosting of process water.
- Fertilizer/ dosing systems.

## Pump HM - HMK

A horizontal multistage centrifugal pump is made of stainless steel.  
The pump is a non-self priming type and fitted with a mechanical shaft seal.

## Operating conditions HM - HMK

Liquid temperature range: 0 °C ~ +110 °C .

Maximum ambient temperature: +52 °C .

Maximum operating pressure: 10 kg/cm<sup>2</sup>.

Maximum inlet pressure is limited by maximum operating pressure.

## Pipe connections

| Connection               | HM(K) 2 | HM(K) 4  | HM(K) 8  | HM(K) 12 |
|--------------------------|---------|----------|----------|----------|
| Suction Port             | Rp 1    | Rp 1 1/4 | Rp 1 1/2 | Rp 1 1/2 |
| Discharge Port           | Rp 1    | Rp 1 1/4 | Rp 1 1/2 | Rp 1 1/2 |
| Drain hole, Priming Hole | G 3/8   | G 3/8    | G 3/8    | G 3/8    |

## Liquids to be pumped

These pumps are designed for pumping freely flowing non-corrosive, non-explosive, and non-flammable liquids. The liquids to be pumped must also be free of solid matter, sands, fibers, and similar materials.

Most common non-highly corrosive watery liquids, oily liquids, hot and cold liquids can be pumped with these pumps.

The suitability of these pumps for pumping any particular liquid depends upon a number of factors, such as the pH value, contents of chemicals such as chlorides, oils, the temperature of the liquids, etc.

Please contact SPCO if there are any questions as to whether certain liquids are suitable for pumping with these pumps.

## Applications HMC - HMN

- Domestic.
- Liquid transfer and circulation of liquids within light industry and farming.
- Pressure boosting.
- Air-conditioning systems.
- Cooling systems or cooling machine
- Specialized OEM equipment

## Pump HMC - HMN

The HMC and HMN series are non-self priming, horizontal multistage centrifugal pumps. pump is coupled with motor at the same shaft and mounted on a base- plate. The friendly design makes the pump suitable for installation in the small domestic or industrial water supply systems. The pump is fitted with a mechanical seal and through (going pump) motor shaft.

**HMC:** The discharge and suction chamber are made of cast iron. The other parts of pump in contact with the liquid are made of stainless steel.

**HMN:** All parts of pump in contact with the liquid are made of stainless steel.  
EPDM or viton O-rings are available as standard.

## Operating conditions HMC - HMN

Liquid: Clean liquid without solid particles.

Liquid temperature range: 0°C ~ +90°C .

Maximum ambient temperature: +52°C .

The maximum operating pressure depends on the temperature of the pumped liquid.

| Max. Operating Pressure | 10 kg/cm <sup>2</sup> | 6 kg/cm <sup>2</sup> |
|-------------------------|-----------------------|----------------------|
| HMC(N) 2, HMC(N) 4      | 0°C to +40°C          | +41°C to +90°C       |
| HMC 8 , HMC 12          | 0°C to +55°C          | +56°C to +90°C       |

Min.inlet pressure: According to the NPSH curve + a safety margin of 0.5m .

Max. inlet pressure: Limited by the max. operating pressure .

## Pipe connections

| Connection               | HMC(N) 2 | HMC(N) 4 | HMC 8    | HMC 12   |
|--------------------------|----------|----------|----------|----------|
| Suction Port             | Rp 1     | Rp 1 1/4 | Rp 1 1/2 | Rp 1 1/2 |
| Discharge Port           | Rp 1     | Rp 1     | Rp 1 1/4 | Rp 1 1/2 |
| Drain hole, Priming Hole | Rc 3/8   | Rc 3/8   | Rp 1/2   | Rp 1/2   |

## Definition of Model

### HM(K) Example

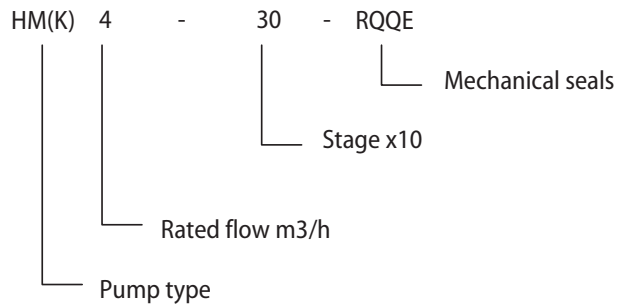

### HMC Example

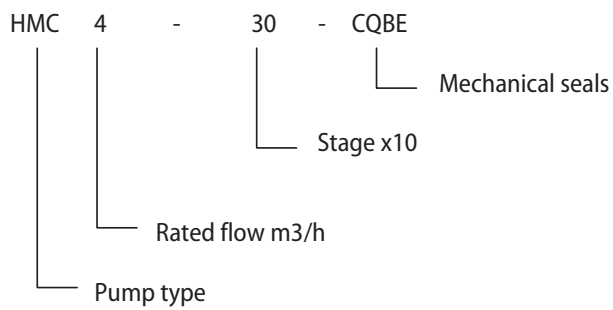

### HMN Example

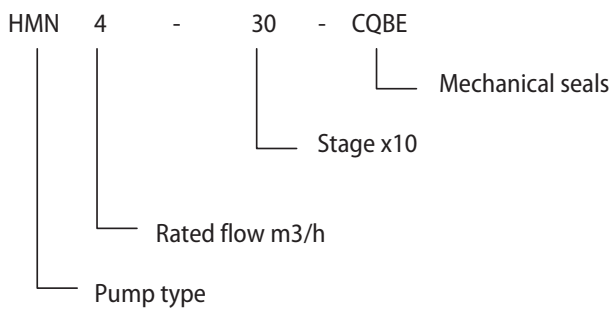

## Electric Motor

The pump is fitted with a totally enclosed, fan-cooled, squirrel-cage motor.

Rated speed: 2850 rpm (50Hz)

Enclosure class: IP 54

Insulation class: F

Standard voltage: 1 x 220 ~ 240 V, 50Hz

3 x 220 ~ 240 V/380 ~ 415 V, 50Hz

## Section drawing HM - HMK

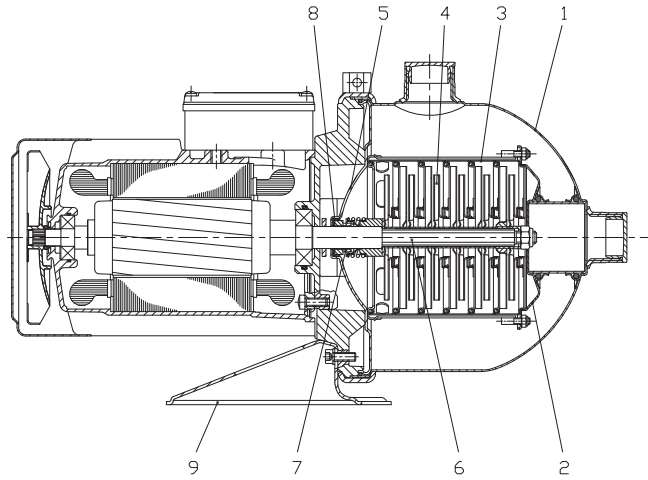

## Material HM - HMK

| No. | Description             | Materials                |                       |
|-----|-------------------------|--------------------------|-----------------------|
|     |                         | HM                       | HMK                   |
| 1   | Pump casing             | SS304                    | SS316                 |
| 2   | Suction inter-connector | SS304                    | SS316                 |
| 3   | Chamber                 | SS304                    | SS316                 |
| 4   | Impeller                | SS304                    | SS316                 |
| 5   | Cover plate             | SS304                    | SS316                 |
| 6   | Shaft                   | SS431                    | SS316                 |
| 7   | Mechanical seal         | Silicon carbide / Carbon | Silicon carbide / Sic |
| 8   | O-ring                  | EPDM or Viton            | EPDM or Viton         |
| 9   | Base plate              | Steel                    | Steel                 |

## Mechanical seal HM - HMK

| List of Materials   |           |
|---------------------|-----------|
| Q : Silicon carbide | E : EPDM  |
| B : Carbon          | V : Viton |
| R : Seal Type       |           |

| Mechanical Seals | HM       | HMK      |
|------------------|----------|----------|
| RQQ              | Optional | •        |
| RQB              | •        | Optional |
| <b>O-ring</b>    |          |          |
| E                | •        | •        |
| V                | •        | •        |

• Standard.



## Section drawing HMC - HMN

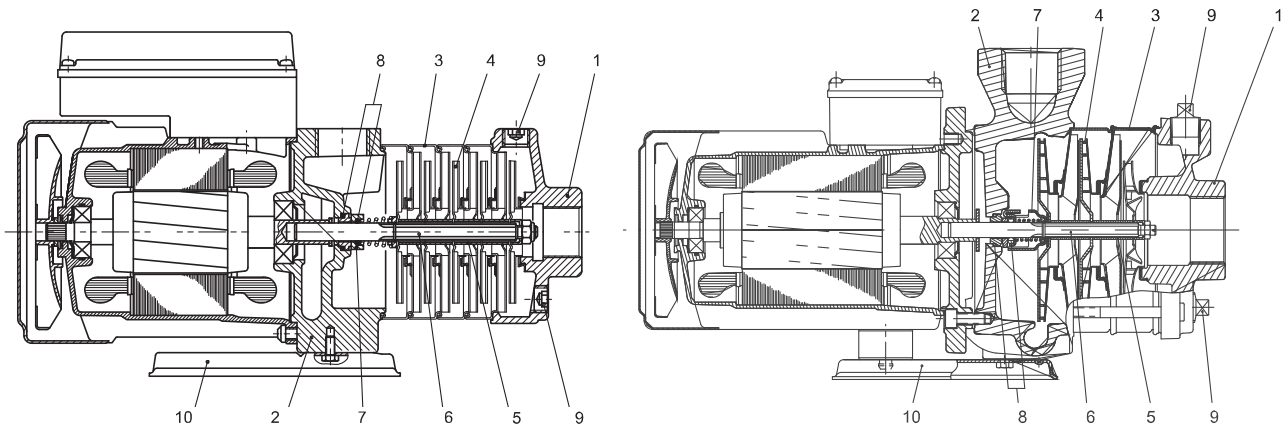

## Material HMC - HMN

| No. | Description            | Materials                |                          |
|-----|------------------------|--------------------------|--------------------------|
|     |                        | HMC                      | HMN                      |
| 1   | Suction chamber        | Cast iron                | SS304                    |
| 2   | Pump head              | Cast iron                | SS304                    |
| 3   | Intermediate chamber   | SS304                    | SS304                    |
| 4   | Impeller               | SS304                    | SS304                    |
| 5   | Spacing pipe           | SS304                    | SS304                    |
| 6   | Shaft                  | SS431                    | SS431                    |
| 7   | Mechanical seal        | Silicon carbide / Carbon | Silicon carbide / Carbon |
| 8   | O-ring                 | EPDM or Viton            | EPDM or Viton            |
| 9   | Drain and priming plug | Steel                    | SS304                    |
| 10  | Base plate             | Steel                    | SS304                    |

## Mechanical seal HMC - HMN

| List of Materials   |              |
|---------------------|--------------|
| Q: Silicon carbide  | E: EPDM      |
| U: Tungsten carbide | V: Viton     |
| B: Carbon           | C: Seal Type |
| A: Seal Type        |              |

| Mechanical Seals | HMC(N) 2, 4 | HMC 8, 12  |
|------------------|-------------|------------|
| CC               | •           | •          |
| CCQ              | Opt i onal  | Opt i onal |
| AUU              | Opt i onal  | Opt i onal |
| O-ring           |             |            |
| E                | •           | •          |
| V                | •           | •          |

• Standard.

Performance curves

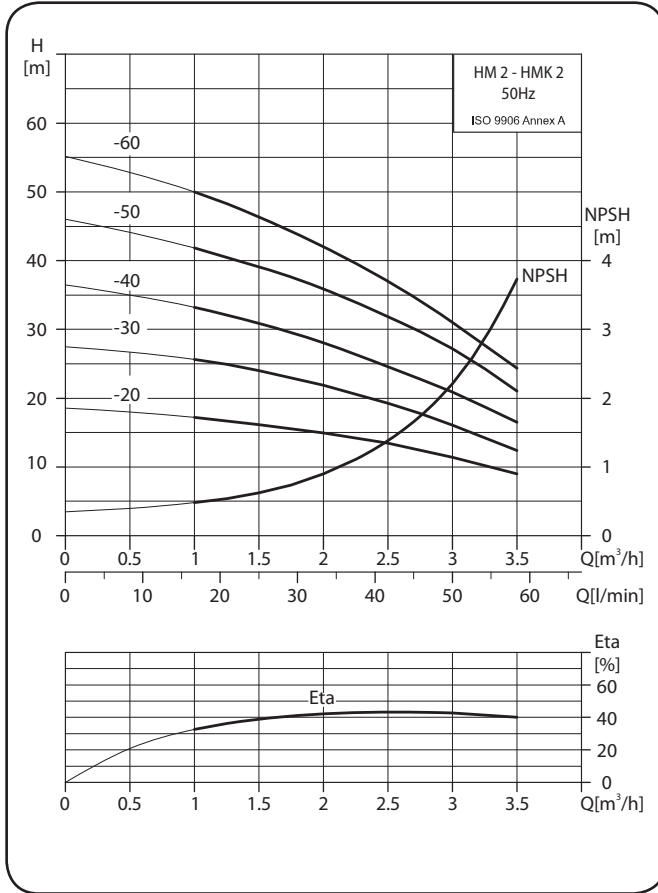

HM 2 - HMK 2

Installation sketch

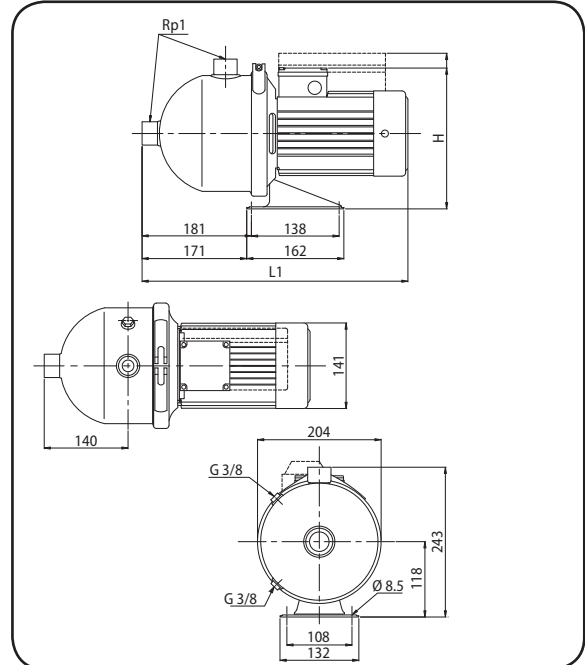

Dimensions and weights

| Model              | Dimension [mm] |     |         |     | Weight [kg] |
|--------------------|----------------|-----|---------|-----|-------------|
|                    | 1-Phase        |     | 3-Phase |     |             |
|                    | L1             | H   | L1      | H   |             |
| HM 2-20 / HMK 2-20 | 403            | 255 | 403     | 233 | 9.6         |
| HM 2-30 / HMK 2-30 | 403            | 255 | 403     | 233 | 9.9         |
| HM 2-40 / HMK 2-40 | 403            | 255 | 403     | 233 | 10.1        |
| HM 2-50 / HMK 2-50 | 403            | 255 | 403     | 233 | 10.8        |
| HM 2-60 / HMK 2-60 | 403            | 255 | 403     | 233 | 11.0        |

Electrical data, 2850 min<sup>-1</sup>

| Model              | 1 x 220-240 V      |                      | 3 x 220-240/380-415 V |                      |
|--------------------|--------------------|----------------------|-----------------------|----------------------|
|                    | P <sub>1</sub> [W] | I <sub>1/1</sub> [A] | P <sub>1</sub> [W]    | I <sub>1/1</sub> [A] |
| HM 2-20 / HMK 2-20 | 450                | 1.9                  | 370                   | 1.9 / 1.1            |
| HM 2-30 / HMK 2-30 | 540                | 2.4                  | 480                   | 1.9 / 1.1            |
| HM 2-40 / HMK 2-40 | 630                | 2.8                  | 620                   | 2.0 / 1.2            |
| HM 2-50 / HMK 2-50 | 800                | 3.8                  | 820                   | 2.7 / 1.6            |
| HM 2-60 / HMK 2-60 | 940                | 4.2                  | 910                   | 2.8 / 1.6            |

## Performance curves

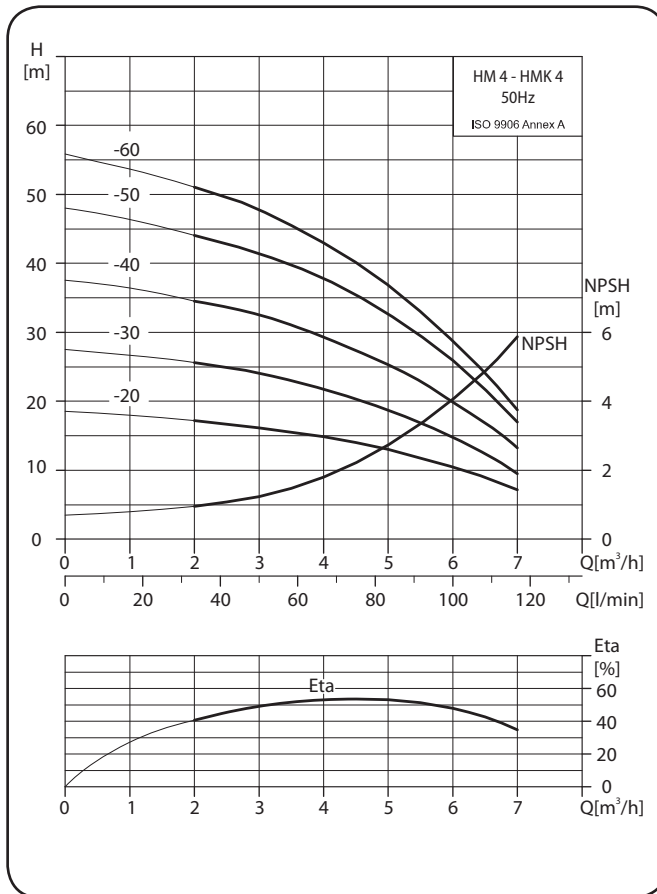

## HM 4 - HMK 4

### Installation sketch

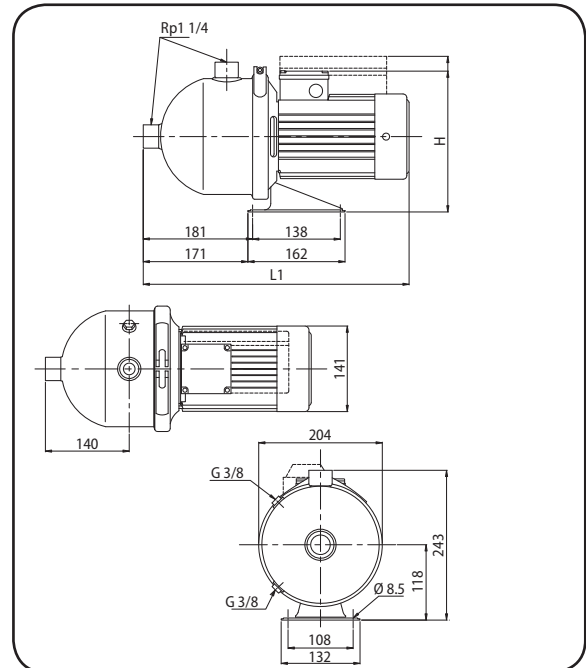

## Dimensions and weights

| Model              | Dimension [mm] |     |         |     | Weight [kg] |
|--------------------|----------------|-----|---------|-----|-------------|
|                    | 1-Phase        |     | 3-Phase |     |             |
|                    | L1             | H   | L1      | H   |             |
| HM 4-20 / HMK 4-20 | 403            | 255 | 403     | 233 | 9.6         |
| HM 4-30 / HMK 4-30 | 403            | 255 | 403     | 233 | 9.9         |
| HM 4-40 / HMK 4-40 | 403            | 255 | 403     | 233 | 10.6        |
| HM 4-50 / HMK 4-50 | 441            | 255 | 441     | 233 | 12.1        |
| HM 4-60 / HMK 4-60 | 441            | 255 | 441     | 233 | 12.3        |

## Electrical data, 2850 min<sup>-1</sup>

| Model              | 1 x 220-240 V      |                      | 3 x 220-240/380-415 V |                      |
|--------------------|--------------------|----------------------|-----------------------|----------------------|
|                    | P <sub>1</sub> [W] | I <sub>1/1</sub> [A] | P <sub>1</sub> [W]    | I <sub>1/1</sub> [A] |
| HM 4-20 / HMK 4-20 | 560                | 2.5                  | 560                   | 2.0 / 1.2            |
| HM 4-30 / HMK 4-30 | 760                | 3.5                  | 720                   | 2.4 / 1.4            |
| HM 4-40 / HMK 4-40 | 1000               | 4.8                  | 980                   | 3.2 / 1.8            |
| HM 4-50 / HMK 4-50 | 1220               | 5.7                  | 1210                  | 4.0 / 2.3            |
| HM 4-60 / HMK 4-60 | 1410               | 6.4                  | 1410                  | 4.8 / 2.7            |

### Performance curves

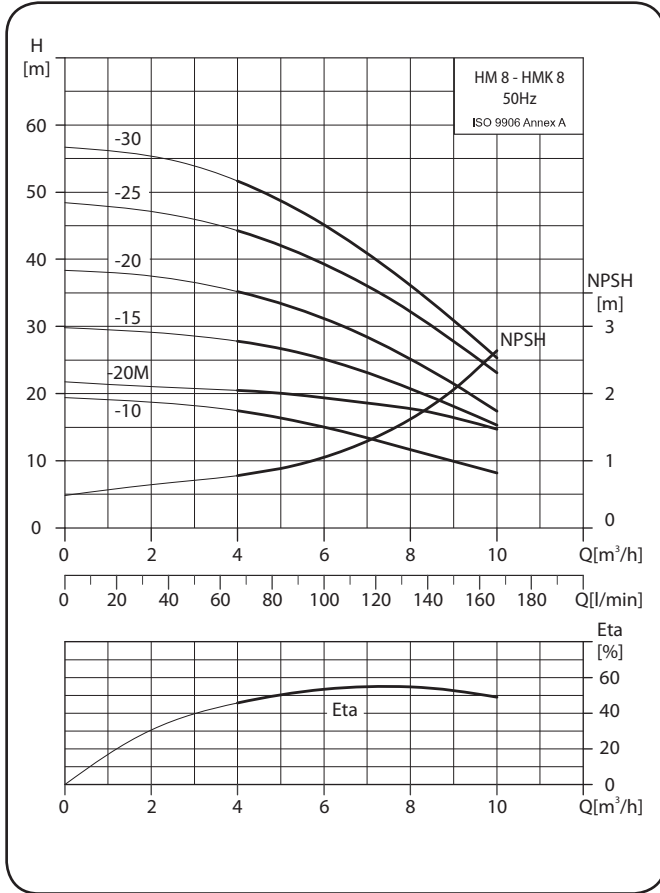

## HM 8 - HMK 8

### Installation sketch

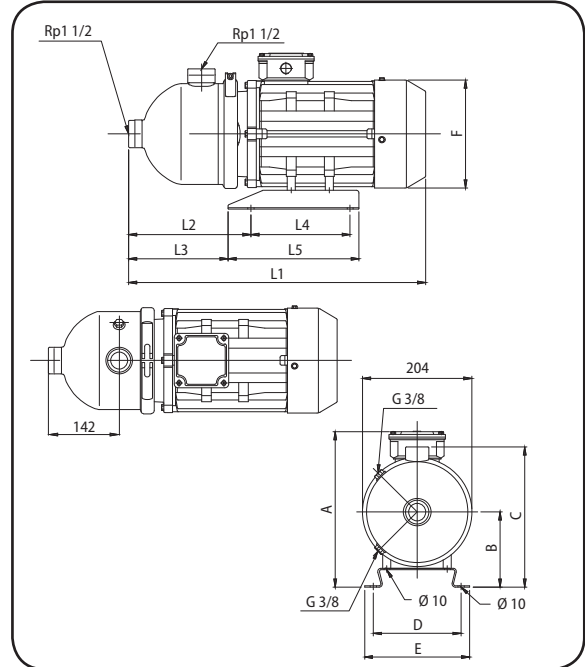

### Dimensions and weights

| Model                | Motor |      | Dimension [mm] |     |     |     |     |     |     |     |     |     |     |     |     | Weight [kg] |       |
|----------------------|-------|------|----------------|-----|-----|-----|-----|-----|-----|-----|-----|-----|-----|-----|-----|-------------|-------|
|                      | P2    |      | L1             |     | L2  | L3  | L4  | L5  | A   |     | B   | C   | D   | E   | F   | 1Ø          | 3Ø    |
|                      | Phase | HP   | 1Ø             | 3Ø  |     |     |     |     | 1Ø  | 3Ø  |     |     |     |     |     |             |       |
| HM 8-10 / HMK 8-10   | 1/3   | 0.75 | 403            | 403 | 181 | 171 | 138 | 162 | 255 | 233 | 118 | 243 | 108 | 132 | 141 | 10.2        | 10.02 |
| HM 8-15 / HMK 8-15   | 1/3   | 1    | 441            | 441 | 181 | 171 | 138 | 162 | 255 | 233 | 118 | 243 | 108 | 132 | 141 | 12.28       | 12.08 |
| HM 8-20M / HMK 8-20M | 3     | 1    | --             | 441 | 181 | 171 | 138 | 162 | --  | 233 | 118 | 243 | 108 | 132 | 141 | --          | 11.98 |
| HM 8-20 / HMK 8-20   | 1/3   | 1.5  | 441            | 441 | 181 | 171 | 138 | 162 | 255 | 233 | 118 | 243 | 108 | 132 | 141 | 13.54       | 13.34 |
| HM 8-25 / HMK 8-25   | 1/3   | 2    | 514            | --  | 200 | 180 | 195 | 235 | 267 | --  | 121 | 245 | 158 | 178 | 177 | 23.08       | --    |
| HM 8-25 / HMK 8-25   | 3     | 1.5  | --             | 441 | 181 | 171 | 138 | 162 | --  | 233 | 118 | 243 | 108 | 132 | 141 | --          | 13.92 |
| HM 8-30 / HMK 8-30   | 1/3   | 2    | 514            | 493 | 200 | 180 | 195 | 235 | 267 | 261 | 121 | 245 | 158 | 178 | 177 | 23.14       | 22.22 |

### Electrical data, 2850 min<sup>-1</sup>

| Model                | 1 x 220-240 V      |                      | 3 x 220-240/380-415 V |                      |
|----------------------|--------------------|----------------------|-----------------------|----------------------|
|                      | P <sub>1</sub> [W] | I <sub>1/1</sub> [A] | P <sub>1</sub> [W]    | I <sub>1/1</sub> [A] |
| HM 8-10 / HMK 8-10   | 720                | 3.4                  | 760                   | 2.9 / 1.7            |
| HM 8-20M / HMK 8-20M | --                 | --                   | 1030                  | 4.1 / 2.4            |
| HM 8-15 / HMK 8-15   | 1150               | 5.4                  | 1180                  | 4.3 / 2.5            |
| HM 8-20 / HMK 8-20   | 1400               | 6.4                  | 1430                  | 5.5 / 3.2            |
| HM 8-25 / HMK 8-25   | 1930               | 8.6                  | 1810                  | 6.0 / 3.5            |
| HM 8-30 / HMK 8-30   | 2100               | 9.3                  | 2050                  | 6.9 / 4.0            |

## Performance curves

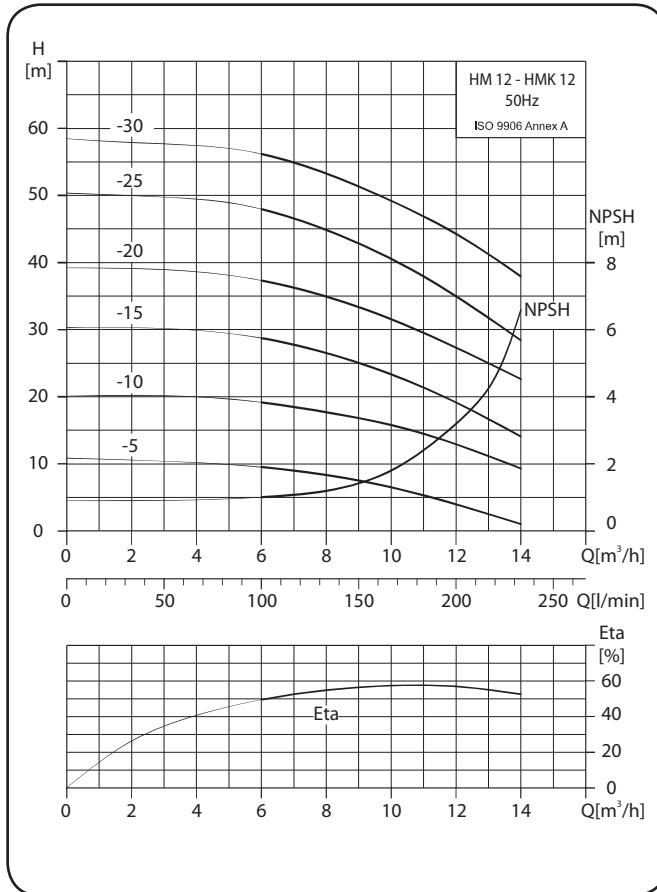

## HM 12 - HMK 12

### Installation sketch

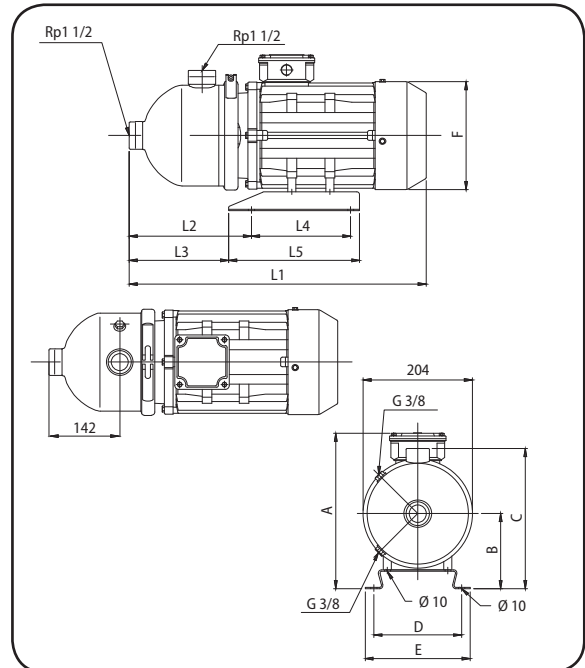

## Dimensions and weights

| Model                | Motor |     | Dimension [mm] |     |     |     |     |     |     |     |     |     |     |     |     | Weight [kg] |       |
|----------------------|-------|-----|----------------|-----|-----|-----|-----|-----|-----|-----|-----|-----|-----|-----|-----|-------------|-------|
|                      | P2    |     | L1             |     | L2  | L3  | L4  | L5  | A   |     | B   | C   | D   | E   | F   | 1Ø          | 3Ø    |
|                      | Phase | HP  | 1Ø             | 3Ø  |     |     |     |     | 1Ø  | 3Ø  |     |     |     |     |     |             |       |
| HM 12-05 / HMK 12-05 | 3     | 0.5 | --             | 403 | 181 | 171 | 138 | 162 | --  | 233 | 118 | 243 | 108 | 132 | 141 | --          | 9.41  |
| HM 12-10 / HMK 12-10 | 1     | 1   | 441            | 441 | 181 | 171 | 138 | 162 | 255 | 233 | 118 | 243 | 108 | 132 | 141 | 11.72       | 11.52 |
|                      | 3     |     |                |     |     |     |     |     |     |     |     |     |     |     |     |             |       |
| HM 12-15 / HMK 12-15 | 1     | 1.5 | 441            | 441 | 181 | 171 | 138 | 162 | 255 | 233 | 118 | 243 | 108 | 132 | 141 | 13.38       | 13.18 |
|                      | 3     |     |                |     |     |     |     |     |     |     |     |     |     |     |     |             |       |
| HM 12-20 / HMK 12-20 | 1     | 2   | 514            | 493 | 200 | 180 | 195 | 235 | 267 | 261 | 121 | 245 | 158 | 178 | 177 | 22.52       | 21.48 |
|                      | 3     |     |                |     |     |     |     |     |     |     |     |     |     |     |     |             |       |
| HM 12-25 / HMK 12-25 | 1     | 3   | 514            | 493 | 200 | 180 | 195 | 235 | 267 | 261 | 121 | 245 | 158 | 178 | 177 | 25.74       | 24.36 |
|                      | 3     |     |                |     |     |     |     |     |     |     |     |     |     |     |     |             |       |
| HM 12-30 / HMK 12-30 | 3     | 4   | --             | 539 | 230 | 198 | 195 | 245 | --  | 284 | 133 | 259 | 174 | 198 | 197 | --          | 30.2  |

## Electrical data, 2850 min<sup>-1</sup>

| Model                | 1 x 220-240 V      |                      | 3 x 220-240/380-415 V |                      |
|----------------------|--------------------|----------------------|-----------------------|----------------------|
|                      | P <sub>1</sub> [W] | I <sub>1/1</sub> [A] | P <sub>1</sub> [W]    | I <sub>1/1</sub> [A] |
| HM 12-05 / HMK 12-05 | --                 | --                   | 550                   | 2.6 / 1.5            |
| HM 12-10 / HMK 12-10 | 1200               | 5.5                  | 1210                  | 4.3 / 2.5            |
| HM 12-15 / HMK 12-15 | 1700               | 7.8                  | 1680                  | 5.9 / 3.4            |
| HM 12-20 / HMK 12-20 | 2460               | 11                   | 2410                  | 7.4 / 4.3            |
| HM 12-25 / HMK 12-25 | 2900               | 13                   | 2870                  | 9.2 / 5.3            |
| HM 12-30 / HMK 12-30 | --                 | --                   | 3640                  | 11.6 / 6.7           |

Performance curves

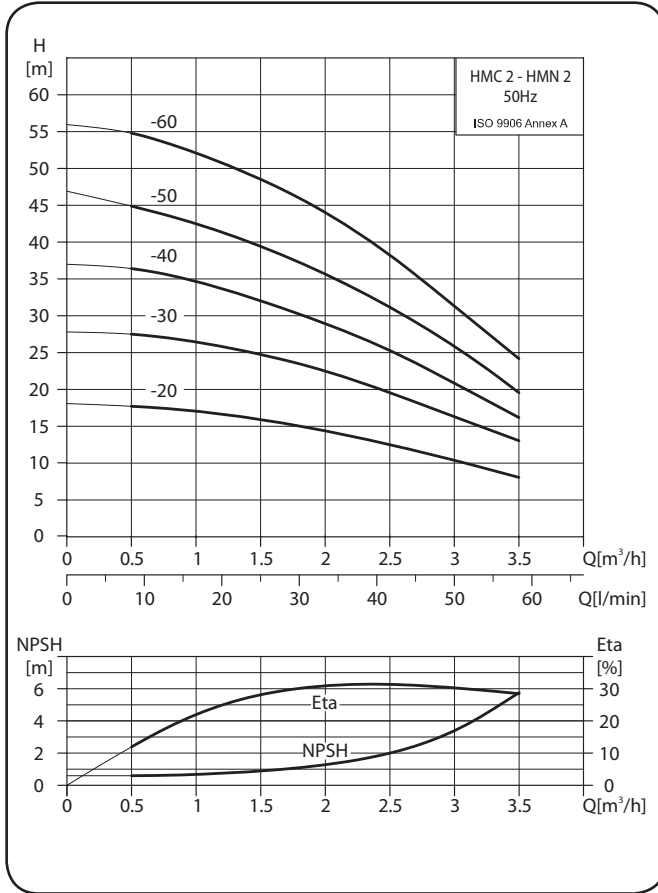

HMC 2 - HMN 2

Installation sketch

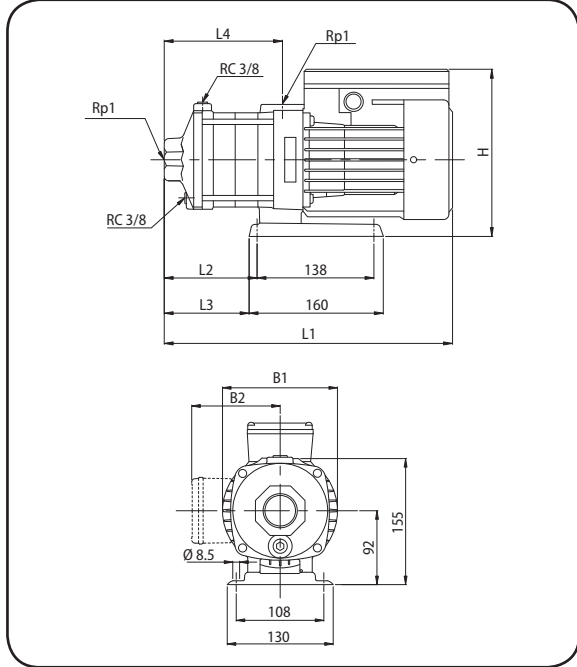

Dimensions and weights

| Model    | Dimension [mm] |     |     |     |     |         |         |         | Weight [kg] |         |         |
|----------|----------------|-----|-----|-----|-----|---------|---------|---------|-------------|---------|---------|
|          | L1             | L2  | L3  | L4  | B1  | B2      |         | H       |             | 1-phase | 3-phase |
|          |                |     |     |     |     | 1-phase | 3-phase | 1-phase | 3-phase     |         |         |
| HMC 2-20 | 309            | 75  | 63  | 101 | 141 | 127     | 112     | 228     | 206         | 10.3    | 10.0    |
| HMC 2-30 | 327            | 93  | 81  | 119 | 141 | 127     | 112     | 228     | 206         | 10.5    | 10.3    |
| HMC 2-40 | 345            | 111 | 99  | 137 | 141 | 127     | 112     | 228     | 206         | 10.8    | 10.5    |
| HMC 2-50 | 363            | 129 | 117 | 155 | 141 | 127     | 112     | 228     | 206         | 11.6    | 11.2    |
| HMC 2-60 | 381            | 147 | 135 | 173 | 141 | 127     | 112     | 228     | 206         | 11.8    | 11.5    |

| Model    | Dimension [mm] |     |     |     |     |         |         |         | Weight [kg] |         |         |
|----------|----------------|-----|-----|-----|-----|---------|---------|---------|-------------|---------|---------|
|          | L1             | L2  | L3  | L4  | B1  | B2      |         | H       |             | 1-phase | 3-phase |
|          |                |     |     |     |     | 1-phase | 3-phase | 1-phase | 3-phase     |         |         |
| HMN 2-20 | 309            | 75  | 63  | 101 | 141 | 127     | 112     | 228     | 206         | 9.1     | 8.8     |
| HMN 2-30 | 327            | 93  | 81  | 119 | 141 | 127     | 112     | 228     | 206         | 9.4     | 9.1     |
| HMN 2-40 | 345            | 111 | 99  | 137 | 141 | 127     | 112     | 228     | 206         | 9.6     | 9.4     |
| HMN 2-50 | 363            | 129 | 117 | 155 | 141 | 127     | 112     | 228     | 206         | 10.4    | 10.1    |
| HMN 2-60 | 381            | 147 | 135 | 173 | 141 | 127     | 112     | 228     | 206         | 10.7    | 10.3    |

Electrical data, 2850 min<sup>-1</sup>

| Model               | 1 x 220-240 V      |                      | 3 x 220-240/380-415 V |                      |
|---------------------|--------------------|----------------------|-----------------------|----------------------|
|                     | P <sub>1</sub> [W] | I <sub>1/1</sub> [A] | P <sub>1</sub> [W]    | I <sub>1/1</sub> [A] |
| HMC 2-20 / HMN 2-20 | 420                | 2.1                  | 380                   | 1.8 / 1.1            |
| HMC 2-30 / HMN 2-30 | 480                | 2.3                  | 460                   | 1.9 / 1.2            |
| HMC 2-40 / HMN 2-40 | 570                | 2.6                  | 560                   | 2.0 / 1.2            |
| HMC 2-50 / HMN 2-50 | 680                | 3.2                  | 660                   | 2.7 / 1.6            |
| HMC 2-60 / HMN 2-60 | 810                | 3.7                  | 810                   | 2.8 / 1.6            |

## Performance curves

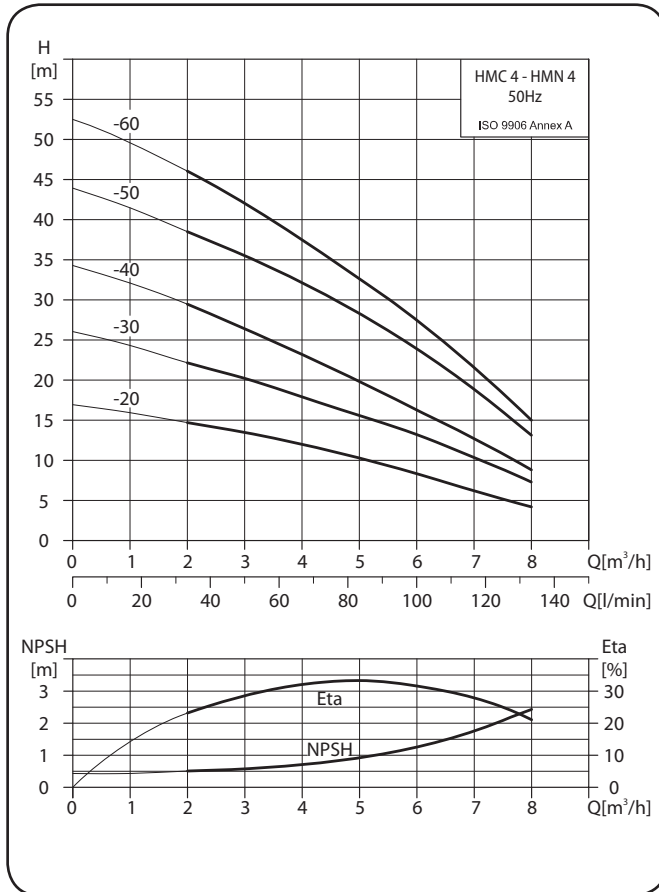

## HMC 4 - HMN 4

### Installation sketch

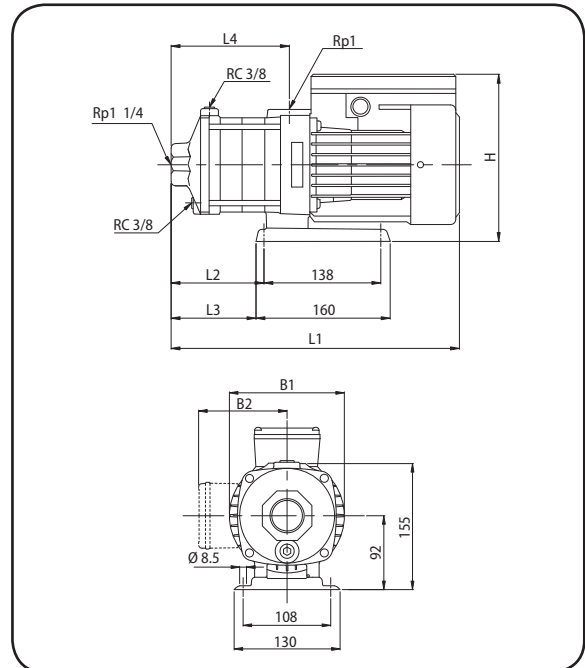

## Dimensions and weights

| Model    | Dimension [mm] |     |     |     |     |         |         |         | Weight [kg] |         |         |
|----------|----------------|-----|-----|-----|-----|---------|---------|---------|-------------|---------|---------|
|          | L1             | L2  | L3  | L4  | B1  | B2      |         | H       |             | 1-phase | 3-phase |
|          |                |     |     |     |     | 1-phase | 3-phase | 1-phase | 3-phase     |         |         |
| HMC 4-20 | 318            | 84  | 72  | 110 | 141 | 127     | 112     | 228     | 206         | 10.4    | 10.1    |
| HMC 4-30 | 344            | 111 | 99  | 137 | 141 | 127     | 112     | 228     | 206         | 10.8    | 10.5    |
| HMC 4-40 | 372            | 138 | 126 | 164 | 141 | 127     | 112     | 228     | 206         | 11.6    | 11.2    |
| HMC 4-50 | 438            | 165 | 153 | 191 | 141 | 127     | 112     | 228     | 206         | 13.4    | 13.1    |
| HMC 4-60 | 465            | 192 | 180 | 218 | 141 | 127     | 112     | 228     | 206         | 14.8    | 14.5    |

| Model    | Dimension [mm] |     |     |     |     |         |         |         | Weight [kg] |         |         |
|----------|----------------|-----|-----|-----|-----|---------|---------|---------|-------------|---------|---------|
|          | L1             | L2  | L3  | L4  | B1  | B2      |         | H       |             | 1-phase | 3-phase |
|          |                |     |     |     |     | 1-phase | 3-phase | 1-phase | 3-phase     |         |         |
| HMN 4-20 | 318            | 84  | 72  | 110 | 141 | 127     | 112     | 228     | 206         | 9.2     | 9.0     |
| HMN 4-30 | 344            | 111 | 99  | 137 | 141 | 127     | 112     | 228     | 206         | 9.6     | 9.3     |
| HMN 4-40 | 372            | 138 | 126 | 164 | 141 | 127     | 112     | 228     | 206         | 10.4    | 10.1    |
| HMN 4-50 | 438            | 165 | 153 | 191 | 141 | 127     | 112     | 228     | 206         | 11.3    | 12.0    |
| HMN 4-60 | 465            | 192 | 180 | 218 | 141 | 127     | 112     | 228     | 206         | 13.6    | 13.4    |

## Electrical data, 2850 min<sup>-1</sup>

| Model               | 1 x 220-240 V      |                      | 3 x 220-240/380-415 V |                      |
|---------------------|--------------------|----------------------|-----------------------|----------------------|
|                     | P <sub>1</sub> [W] | I <sub>1/1</sub> [A] | P <sub>1</sub> [W]    | I <sub>1/1</sub> [A] |
| HMC 4-20 / HMN 4-20 | 540                | 2.4                  | 560                   | 2.0 / 1.2            |
| HMC 4-30 / HMN 4-30 | 820                | 3.5                  | 770                   | 2.3 / 1.3            |
| HMC 4-40 / HMN 4-40 | 1020               | 4.3                  | 1000                  | 3.1 / 1.8            |
| HMC 4-50 / HMN 4-50 | 1220               | 5.4                  | 1200                  | 4.0 / 2.3            |
| HMC 4-60 / HMN 4-60 | 1450               | 6.2                  | 1400                  | 4.6 / 2.7            |

Performance curves

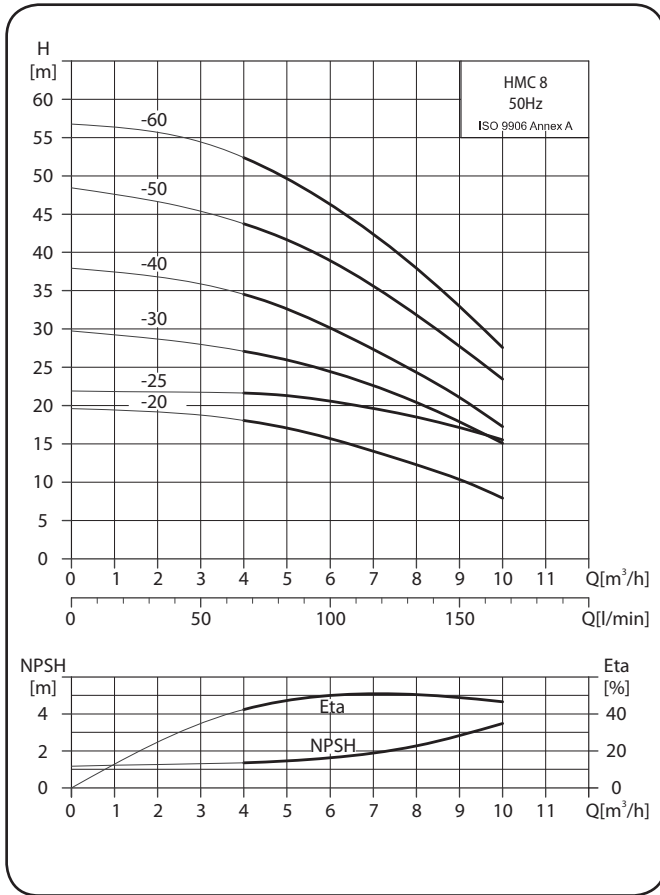

HMC 8

Installation sketch

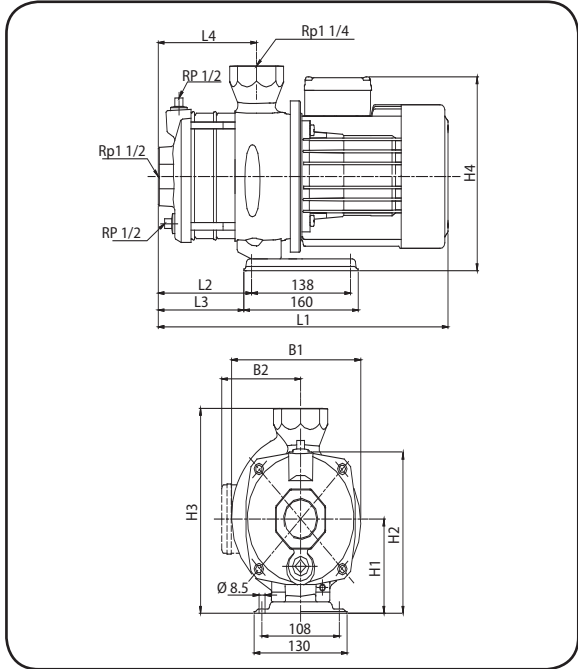

Dimensions and weights

| Model    | Dimension [mm] |     |     |     |     |     |     |     |     |     |     |     | Weight [kg] |     |      |      |
|----------|----------------|-----|-----|-----|-----|-----|-----|-----|-----|-----|-----|-----|-------------|-----|------|------|
|          | L1             |     | L2  | L3  | L4  | B1  |     | B2  |     | H1  | H2  | H3  | H4          |     | 1Ø   | 3Ø   |
|          | 1Ø             | 3Ø  |     |     |     | 1Ø  | 3Ø  | 1Ø  | 3Ø  |     |     |     | 1Ø          | 3Ø  |      |      |
| HMC 8-20 | 320            | 320 | 54  | 42  | 78  | 181 | 181 | 136 | 116 | 112 | 190 | 240 | 248         | 228 | 17.2 | 17.0 |
| HMC 8-25 | --             | 390 | 84  | 72  | 108 | --  | 181 | --  | 116 | 112 | 190 | 240 | --          | 228 | --   | 19.1 |
| HMC 8-30 | 390            | 390 | 84  | 72  | 108 | 181 | 181 | 136 | 116 | 112 | 190 | 240 | 248         | 228 | 19.5 | 19.2 |
| HMC 8-40 | 390            | 390 | 84  | 72  | 108 | 181 | 181 | 136 | 116 | 112 | 190 | 240 | 248         | 228 | 20.7 | 20.5 |
| HMC 8-50 | 478            | 420 | 132 | 120 | 138 | 185 | 181 | 156 | 116 | 112 | 190 | 240 | 268         | 228 | 27.9 | 21.4 |
| HMC 8-60 | 478            | 478 | 132 | 120 | 138 | 185 | 185 | 156 | 141 | 112 | 190 | 240 | 268         | 253 | 28.1 | 27.0 |

Electrical data, 2850 min<sup>-1</sup>

| Model    | 1 x 220-240 V      |                      | 3 x 220-240/380-415 V |                      |
|----------|--------------------|----------------------|-----------------------|----------------------|
|          | P <sub>1</sub> [W] | I <sub>1/1</sub> [A] | P <sub>1</sub> [W]    | I <sub>1/1</sub> [A] |
| HMC 8-20 | 740                | 3.4                  | 720                   | 2.6 / 1.5            |
| HMC 8-25 | --                 | --                   | 960                   | 3.5 / 2.0            |
| HMC 8-30 | 1130               | 5.2                  | 1100                  | 3.8 / 2.2            |
| HMC 8-40 | 1400               | 6.3                  | 1350                  | 5.0 / 2.9            |
| HMC 8-50 | 1890               | 8.6                  | 1730                  | 6.0 / 3.5            |
| HMC 8-60 | 2150               | 9.8                  | 2040                  | 6.4 / 3.7            |



## Performance curves

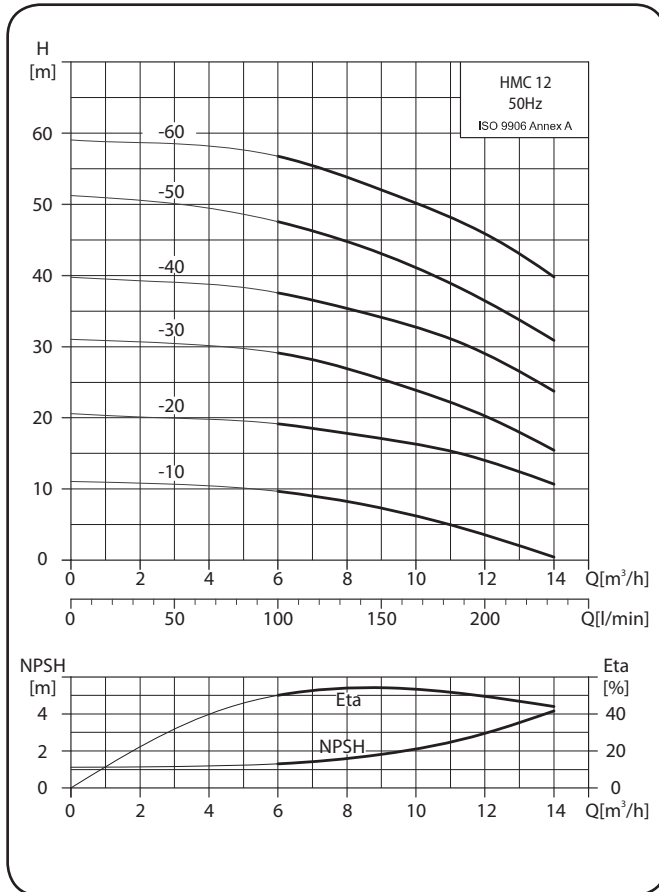

## HMC 12

### Installation sketch

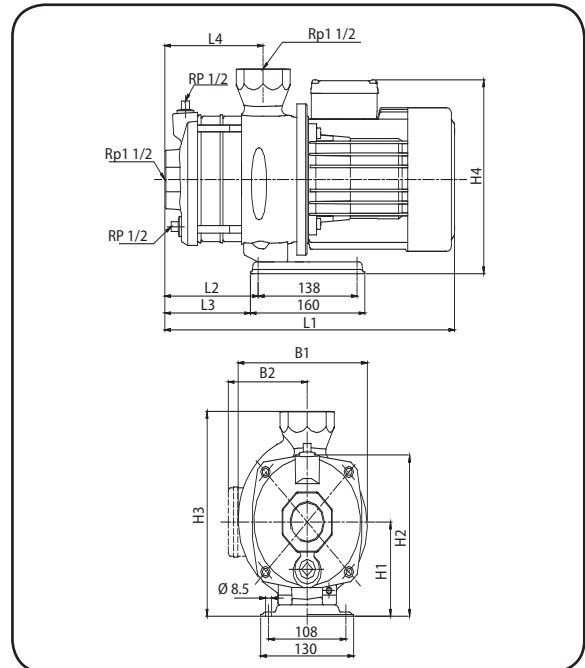

## Dimensions and weights

| Model     | Dimension [mm] |     |     |     |     |     |     |     |     |     |     | Weight [kg] |     |     |       |       |
|-----------|----------------|-----|-----|-----|-----|-----|-----|-----|-----|-----|-----|-------------|-----|-----|-------|-------|
|           | L1             |     | L2  | L3  | L4  | B1  |     | B2  |     | H1  | H2  | H3          | H4  |     | 1Ø    | 3Ø    |
|           | 1Ø             | 3Ø  |     |     |     | 1Ø  | 3Ø  | 1Ø  | 3Ø  |     |     |             | 1Ø  | 3Ø  |       |       |
| HMC 12-10 | --             | 320 | 54  | 42  | 78  | --  | 181 | --  | 116 | 112 | 190 | 240         | --  | 228 | --    | 17.85 |
| HMC 12-20 | 360            | 360 | 54  | 42  | 78  | 181 | 181 | 136 | 116 | 112 | 190 | 240         | 248 | 228 | 18.35 | 18.15 |
| HMC 12-30 | 390            | 390 | 84  | 72  | 108 | 181 | 181 | 136 | 116 | 112 | 190 | 240         | 248 | 228 | 20.62 | 20.40 |
| HMC 12-40 | 448            | 448 | 102 | 90  | 108 | 185 | 185 | 156 | 141 | 112 | 190 | 240         | 268 | 253 | 27.05 | 26.05 |
| HMC 12-50 | 478            | 450 | 132 | 120 | 138 | 185 | 185 | 156 | 141 | 112 | 190 | 240         | 268 | 253 | 29.22 | 29.30 |
| HMC 12-60 | --             | 503 | 132 | 120 | 138 | --  | 196 | --  | 147 | 125 | 203 | 253         | --  | 272 | --    | 34.58 |

## Electrical data, 2850 min<sup>-1</sup>

| Model     | 1 x 220-240 V      |                      | 3 x 220-240/380-415 V |                      |
|-----------|--------------------|----------------------|-----------------------|----------------------|
|           | P <sub>1</sub> [W] | I <sub>1/1</sub> [A] | P <sub>1</sub> [W]    | I <sub>1/1</sub> [A] |
| HMC 12-10 | --                 | --                   | 560                   | 2.4 / 1.4            |
| HMC 12-20 | 1170               | 5.4                  | 1140                  | 3.8 / 2.2            |
| HMC 12-30 | 1710               | 7.6                  | 1650                  | 5.9 / 3.4            |
| HMC 12-40 | 2360               | 10.4                 | 2300                  | 7.1 / 4.1            |
| HMC 12-50 | 2850               | 13                   | 2820                  | 9.1 / 5.3            |
| HMC 12-60 | --                 | --                   | 3500                  | 11.1 / 6.4           |



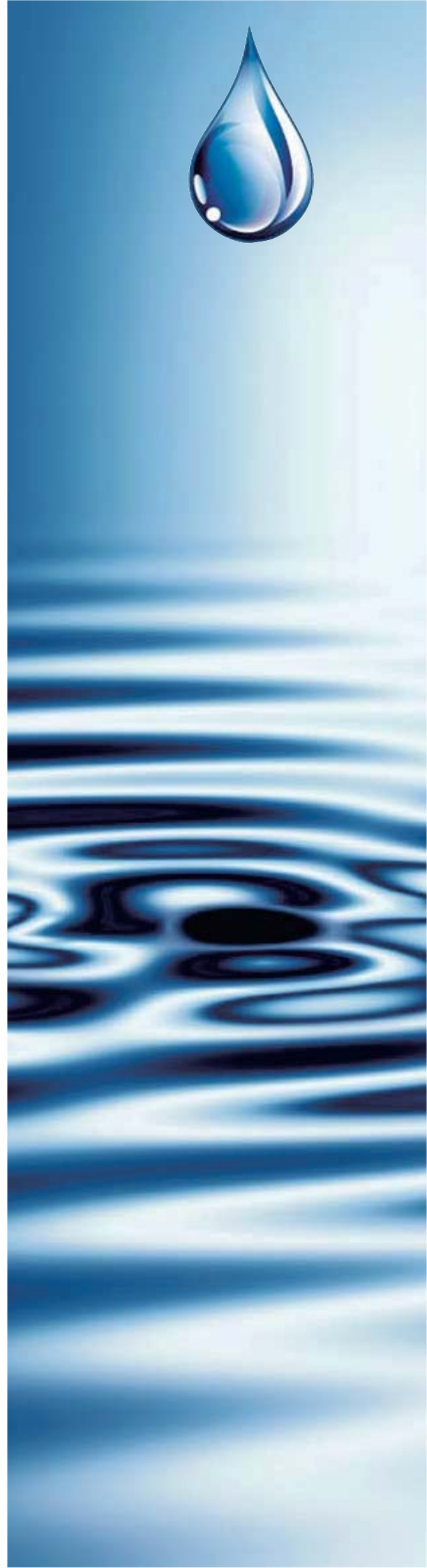



Swiss Pump Company AG  
Moosweg 36  
CH - 3645 Thun - Gwatt  
Switzerland  
Tel. +41 33 223 11 00  
Fax +41 33 223 11 22  
mail@swisspump.com

[www.swisspump.com](http://www.swisspump.com)